

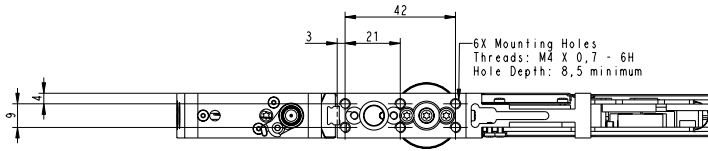

# ZEUS Product Drawings and Dimensions in mm (Straight Configuration)

Bottom



Side

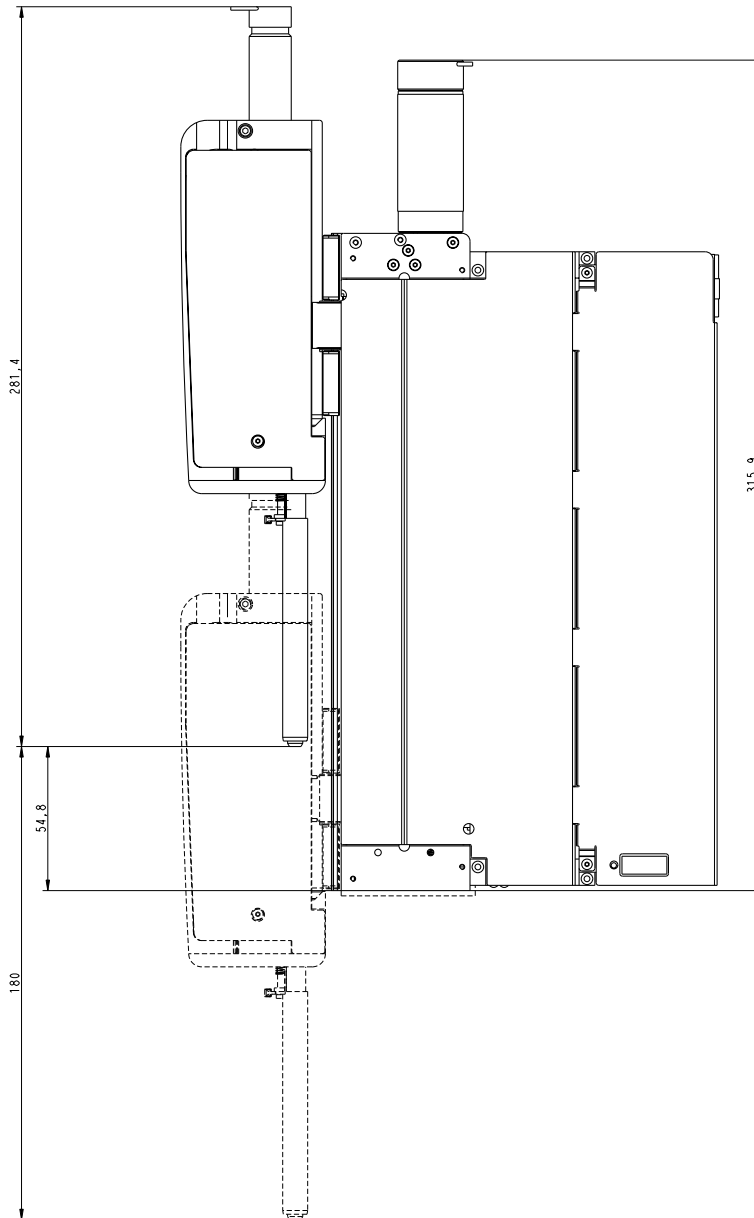

Front

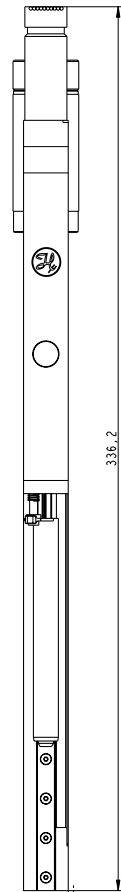

Top

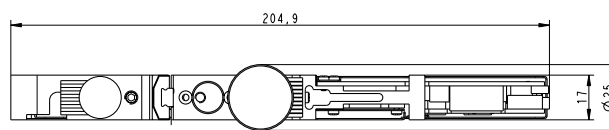

## Product Specifications

Dimensions (Width x Depth x Height)	Straight configuration: 25 mm x 205 mm x 337 mm	Folded configuration: 45 mm x 118 mm x 337 mm	Right angle configuration: 161 mm x 102 mm x 337 mm
--	--	--	--

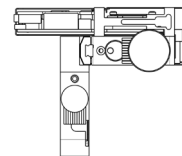
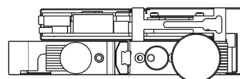

Weight	1100 g		
z-Drive	Maximum z-Excursion	180 mm	
	Resolution z-Axis	0.1 mm	
	Maximum Speed z-Axis	350 mm/s	
Pipetting Drive	Volume Range	1 µL – 1000 µL	
	Resolution	0.1 µL	
	Maximum Speed	150 mm/s corresponding to 2'500 µL/s	
Pipetting Mode	Single and aliquot dispensing		
Process Security	Tip presence sensor		
	Pressure-based and capacitive Liquid Level Detection (cLLD and pLLD)		
	Qualitative Pipetting Monitoring (QPM)		
	Anti-Droplet Control (ADC)		
Operating Data	Power requirement	48 VDC ± 5%, 1 A	
	Temperature range	18°C – 32°C	
	Relative humidity	40% – 80% (non-condensing)	
	Noise level	< 60 dBA, Indoor use only	
Storage and Transportation	Temperature range	-25°C – +70°C	
	Relative humidity	40% – 80% (non-condensing, indoors)	
Communication	CAN (Hamilton protocol), FCC connector		
	Selectable baud rates	125, 500 kBaud (others on request)	
	Device addressing	up to 31 modules on a single CAN bus	

Pipetting Performance*	Disposable Tip Size	Pipetting Volume	Accuracy	Precision
		10 µL	1 µL	5.0%
	10 µL	5 µL	2.5%	1.5%
	10 µL	10 µL	1.5%	1.0%
	50 µL	1 µL	5.0%	4.0%
	50 µL	5 µL	2.5%	1.5%
	50 µL	50 µL	2.0%	0.75%
	300 µL	10 µL	5.0%	2.0%
	300 µL	50 µL	2.0%	0.75%
	300 µL	300 µL	1.0%	0.75%
	1000 µL	10 µL	7.5%	3.5%
	1000 µL	100 µL	2.0%	0.75%
	1000 µL	1000 µL	1.0%	0.75%

\* Pipetting specifications were determined gravimetrically using a high precision balance and strictly controlled environmental conditions: test temperature: 20 ± 2°C, relative humidity: 50% ± 5%, test liquid temperature range: ≤± 0.5°C of room temperature; balance used: Mettler Toledo MX5.

The measurements were done with Hamilton Verification Solution (deionized water with 0.1% NaCl and 0.01% Tween detergent) using standard CO-RE conductive tips. A new tip was used for each pipetting cycle (aspiration and dispense). At least 10 points were taken for each volume and pipetting module. Volumes > 20 µL were dispensed in jet mode. Volumes ≤ 20 µL were dispensed in surface mode. Results may vary using other liquid or environmental conditions.

## Ordering Information

### ZEUS Pipetting Module

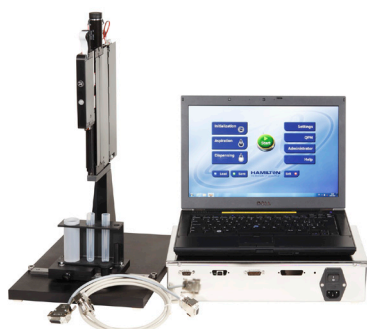

Test platform

Part Number	Description	Includes
800700	ZEUS CO-RE module	
202977-0020	Test platform	Holder for the ZEUS module, and Communication box
202977-0021	Holder for ZEUS module	
202977-0022	Communication box	USB / Hamilton CAN converter, power supply, cables and software CD

### Disposable CO-RE Tips\*

Part Number	Description				
235904-ZEUS	1000 µL tip	non-filtered	conductive	40 racks of 96	
235905-ZEUS	1000 µL tip	filtered	conductive	40 racks of 96	
235902-ZEUS	300 µL tip	non-filtered	conductive	60 racks of 96	
235903-ZEUS	300 µL tip	filtered	conductive	60 racks of 96	
235806-ZEUS	300 µL slim tip	non-filtered	conductive	40 racks of 96	
235647-ZEUS	300 µL slim tip	filtered	conductive	40 racks of 96	
235966-ZEUS	50 µL tip	non-filtered	conductive	60 racks of 96	
235948-ZEUS	50 µL tip	filtered	conductive	60 racks of 96	
235900-ZEUS	10 µL tip	non-filtered	conductive	60 racks of 96	
235901-ZEUS	10 µL tip	filtered	conductive	60 racks of 96	

\* Other tips available on request

### Accessories and Spare Parts



CO-RE adapter



Holder for CO-RE tip rack

Tip ejection sleeve

Part Number	Description
800336	Holder for CO-RE tip rack
800337	Tip ejection sleeve (1/pk)
800339	CO-RE adapter (1/pk)

© 2013 Hamilton Company. All rights reserved.  
All trademarks are owned and/or registered by Hamilton Company in the U.S. and/or other countries.  
Lit. No. 608770/02 – 09/2013

# HAMILTON®

Web: [www.hamiltoncompany.com](http://www.hamiltoncompany.com)

USA: 800-648-5950

Europe: +41-81-660-60-60

**Hamilton Americas & Pacific Rim**  
4970 Energy Way  
Reno, Nevada 89502 USA  
Tel: +1-775-858-3000  
Fax: +1-775-856-7259  
[sales@hamiltoncompany.com](mailto:sales@hamiltoncompany.com)

**Hamilton Europe, Asia, & Africa**  
Via Crusch 8  
CH-7402 Bonaduz, Switzerland  
Tel: +41-81-660-60-60  
Fax: +41-81-660-60-70  
[contact@hamilton.ch](mailto:contact@hamilton.ch)

To find a representative in your area, please visit [hamiltoncompany.com/contacts](http://hamiltoncompany.com/contacts).